



# SLE 2023

**Societas Linguistica Europaea**

**56th Annual Meeting**

**29 August – 1 September 2023**

**National and Kapodistrian University of Athens, Greece**

**School of Philosophy**

**Time zone: Eastern European Summer Time (GMT+3)**

**CONFERENCE SCHEDULE**



HELLENIC REPUBLIC

**National and Kapodistrian  
University of Athens**

EST. 1837



**SCHOOL OF PHILOSOPHY**

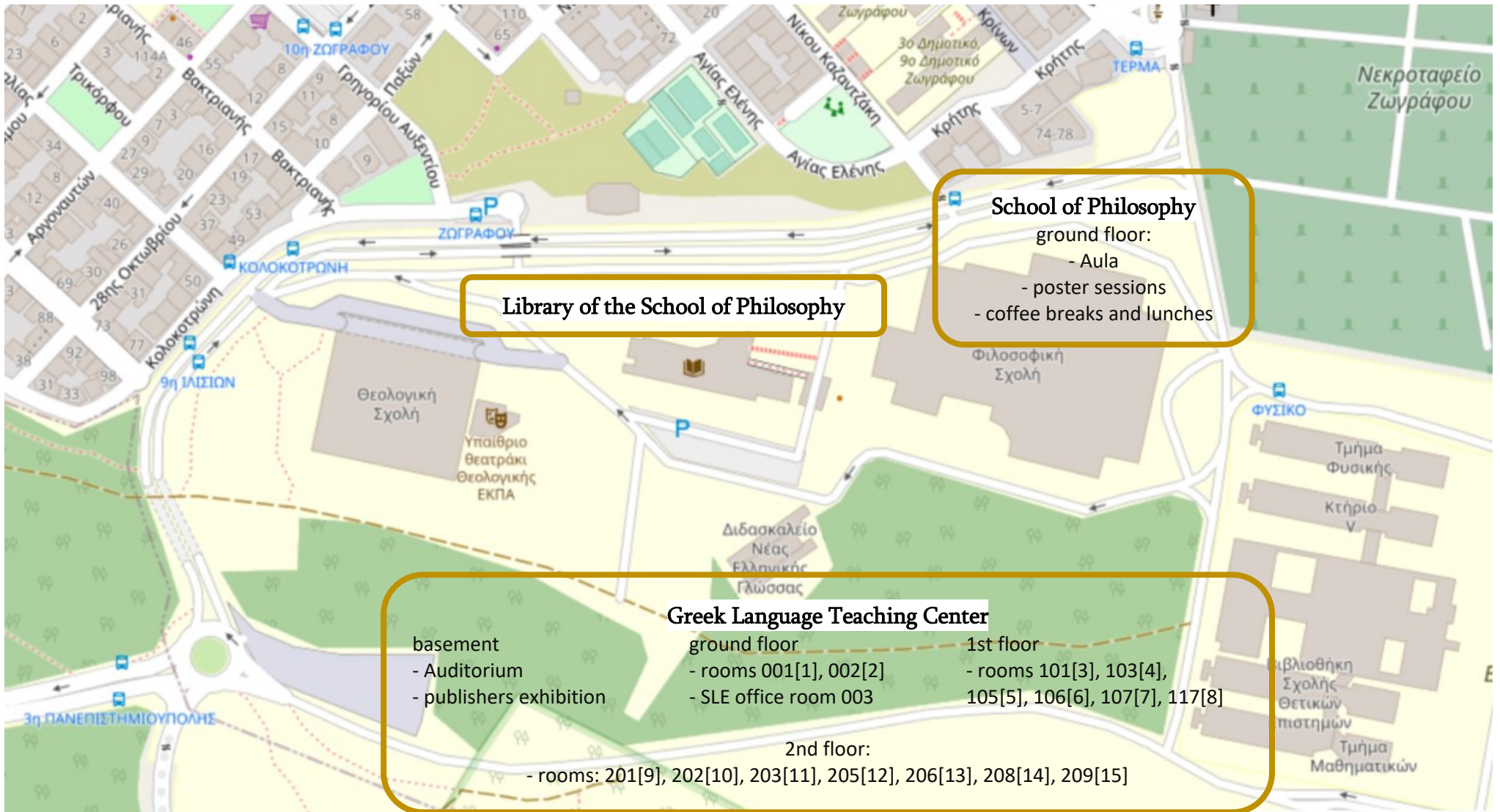

**Library of the School of Philosophy**

**School of Philosophy**  
ground floor:  
- Aula  
- poster sessions  
- coffee breaks and lunches

**Greek Language Teaching Center**

basement	ground floor	1st floor
- Auditorium	- rooms 001[1], 002[2]	- rooms 101[3], 103[4],
- publishers exhibition	- SLE office room 003	105[5], 106[6], 107[7], 117[8]
	2nd floor:	
	- rooms: 201[9], 202[10], 203[11], 205[12], 206[13], 208[14], 209[15]	

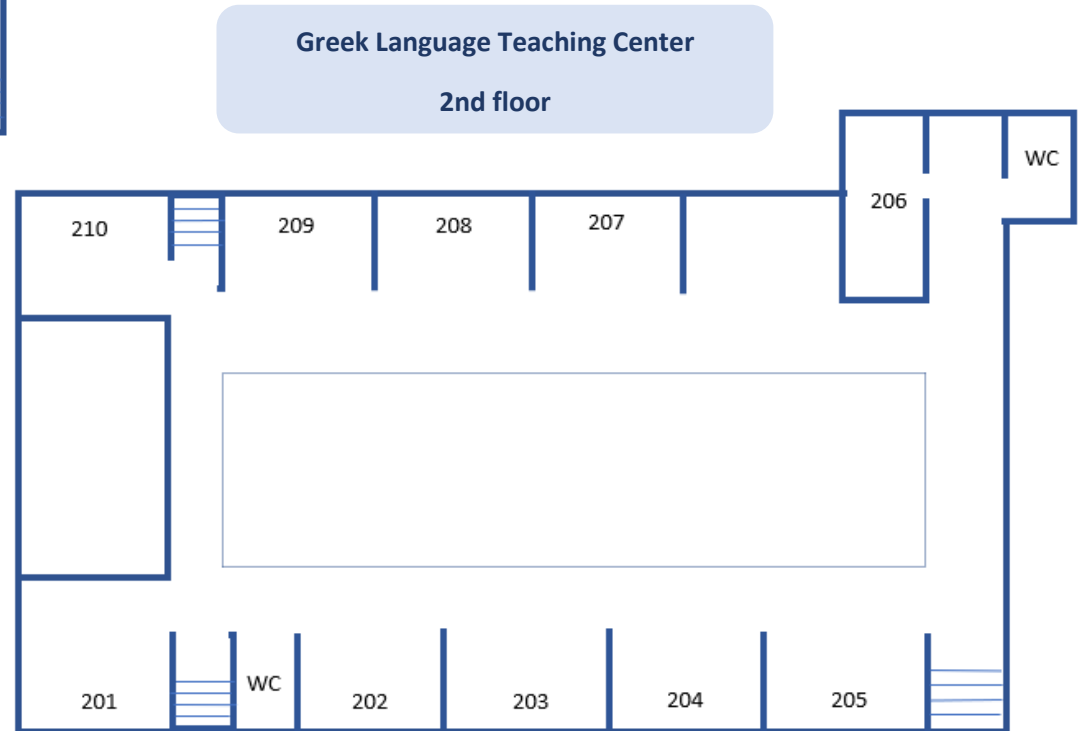
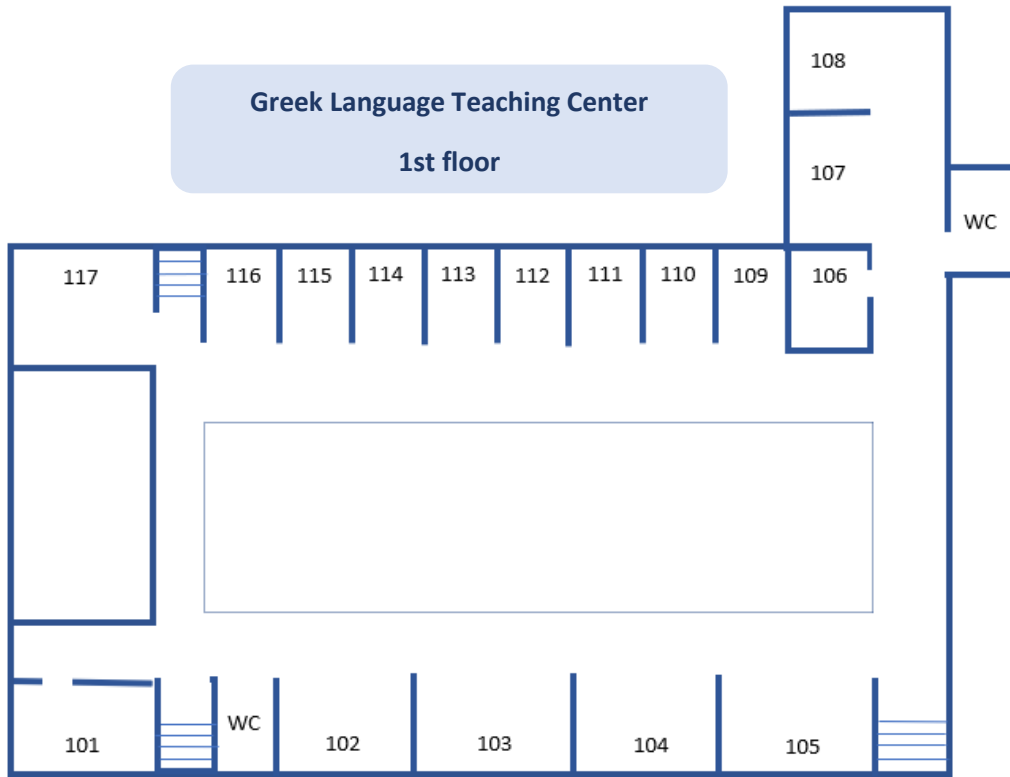

**MONDAY 28 AUGUST**

16.00-20.00	REGISTRATION ( <i>Modern Greek Language Teaching Centre</i> )
-------------	---

**TUESDAY 29 AUGUST**

8.00-9.00	REGISTRATION ( <i>Modern Greek Language Teaching Centre</i> )
-----------	---

9.00-9.25	OPENING SESSION ( <i>Aula of the School of Philosophy</i> )
-----------	---

9.30-10.25	PLENARY PRESIDENTIAL ADDRESS: Arie Verhagen (Leiden), Scientific explanation and the unity of linguistics ( <i>Aula of the School of Philosophy</i> )
------------	---

10.30-11.00	coffee break ( <i>Modern Greek Language Teaching Centre</i> )
-------------	---

	1 [001]	2 [002]	3 [101]	4 [103]	5 [105]	6 [106]	7 [107]	8 [117]	9 [201]	10 [202]	11 [203]	12 [205]	13 [206]	14 [208]	15 [209]
	GS Language contact	GS Semantics	WS1 Diachronic Morphosyntax			GS Clause-linkage	WS4 Expressing surprise	GS Sociolinguistics I	GS Modality	WS 12 Questions in Monologic Discourse	GS Historical phonology I	WS20 Verbal periphrases in Romance	GS Pragmatics and stylistics	GS Typology	GS Case marking
	CHAIR: HENRIK LILJEGREN	CHAIR: EVANGELIA VLACHOU			CHAIR: GIUSEPPINA DI BARTOLO		CHAIR: THEODOSSIA-SOULA PAVLIDOU	CHAIR: KALLE MÜLLER		CHAIR: SUNE GREGERSEN		CHAIR: SPYRIDOULA BELLA	CHAIR: EVANGELIA ADAMOUC	CHAIR: JOHANNES KABATEK	
11.00-11.25	Huber		Estigarribia & Gerardi			Salaberri	Rodríguez Rosique	Kyriazi	Krifka & Modarresi	Celle & Mendes	Honkasalo & Gates	Sansiñena Pascual, Enghels & Del Mar Garachana Camarero	Stolac & Vlastelić	Banks	Bondaruk & Rozwadowska
11.30-11.55	Blum	Duguine & Irurtzun	Mattiola & Krasnoukhova			van der Auwera, Mosegaard Hansen & Van Olmen	DeLancey,	Filippou	Soares Da Silva	Silvano, Oleškevičienė, Damova, & Liebeskind	Mendez Dosuna	Dessi Schmid,, Wiesinger & Momma	Marinis & Joseph	Ennever, Knudsen & Yacopetti	Gunkel & Hartmann
12.00-12.25	Starchenko	Vergaro	Seifart			Vorholt	Maldonado & De la Mora	Potapenko & Talavira	Nuyts	Zeyrek & Mendes	Auderset & Campbell	Pahontu	Gradečak & Babić	Shcherbakova, Evers, Gray & Greenhil	Menschel & Wojtylak
12.30-12.55	Arnold	Geist	Urban			Royo Viñuales	Mari	Georgalou	Dendale & Stulic	Cortez Espinoza & Onea		Füreder	Kaukonen & Risberg	Khokhlova & Zakharyin	Ribera

13.00-14.00	lunch ( <i>Modern Greek Language Teaching Centre</i> )
-------------	--

14.00-14.30	Anna Siewierska Award and Coseriu Award ( <i>Aula of the School of Philosophy</i> )
-------------	---

	1	2	3	4	5	6	7	8	9	10	11	12	13	14	15
	GS Areal linguistics	GS Causatives	WS1 Diachronic Morphosyntax	GS Language acquisition	GS Word formation	GS Clause-linkage	WS4 Expressing surprise	GS Sociolinguistics	GS Modality	WS12	WS18 Impoliteness	WS20	WS5 Inflection	GS Typology	GS Case marking

	CHAIR: <b>LIDIA MAZZITELLI</b>	CHAIR: <b>MARTIN HASPELMATH</b>		CHAIR: <b>MARIA KHACHATURYAN</b>	CHAIR: <b>MINA GIANNOULAKI</b>	CHAIR: <b>IKER SALABERRI</b>		CHAIR: <b>ANGELIKI ALVANOUDI</b>	CHAIR: <b>PATRICK DENDALE</b>	Questions in Monologic Discourse		Verbal periphrases in Romance		CHAIR: <b>SONIA CRISTOFARO</b>	CHAIR: <b>EVANGELIA VLACHOU</b>
14.30-14.55	Kozhanov & Say	Ferrarotti, Cornillie, Gorla, Inglese & Mazzola	Roksandic	Wrembel, Balas, Kaźmierski & Weckwerth	Sevcikova	Luk	Vancauwenbergh, De Wit & Petré	Garrido	Quartararo	Kaneko	Andersson, Van Olmen, Culpeper & Giomi	Danckaert & Stein	Matushansky, Marelj & Tatevosov	Kabatek & Zeugin	Miestamo, Shagal, Silvennoinen & Yurayong
15.00-15.25	Rohleder	Moretti	Rosés Labrada	Matzinger, Pleyer, Qing Zhang & Zywiczyński	Belosevic	di Bartolo	González & Reglero	Gorla & Gasparini	Greco	Lelandais & Alkhateeb	Van Huyssteen, Breed & Pilon	Thegel	Klimek-Jankowska, Simeonova, Blazheska, Tunteva, Frasson & Shlikhutka	Szmrecsanyi, Gardner & Van Hoey	Berikashvili
15.30-15.55	Authier	Ariño Bizarro	Coelho Aragon	Saad & Arnold	Arndt-Lappe & Beliaeva	ten Wolde & Kaltenböck	Cifuentes	Roncero	Marongiu	Celle & Cardo	Paternoster	Van Hulle & Enghels	Biskup	Meakins	Aigro

16.00-16.30 *coffee break (Modern Greek Language Teaching Centre)*

	1	2	3	4	5	6	7	8	9	10	11	12	13	14	15
	GS Areal linguistics	GS Semantics	WS1 Diachronic Morphosyntax	WS19 Translations in the history of languages	GS Causality	GS Clause-linkage	WS4 Expressing surprise	WS14 Similarity of quality		WS12 Questions in Monologic Discourse	WS18 Impoliteness	WS20 Verbal periphrases in Romance	WS5 Inflection	GS Adverbs and adverbials	GS Phonetics and phonology
	CHAIR: <b>BRIAN JOSEPH</b>	CHAIR: <b>KAROLINA GRZECH</b>			CHAIR: <b>MANFRED KRIFKA</b>	CHAIR: <b>JOHAN VAN DER AUWERA</b>								CHAIR: <b>ARGYRO MOUSTAKI</b>	CHAIR: <b>IANTHI TSIMPLI</b>
16.30-16.55	Milanova, Honkola & Metsäranta	Fonteyn, Karsdorp & Manjavacas	Wojtylak & Alvaro Echeverri	Lavidas, Crellin, Eckhoff, Haug	Say, Logvinova & Zabelina	Mazzola	Sánchez López	Kisiel & Kolyaseva		Bondarenko	Van Olmen & Andersson	Nieuwenhuisen	Manova	Letuchiy	Apostolopoulos
17.00-17.25	Morozova et al.	Russi & Nishdia	Van linden & Ferraz Gerardi	Benedetti, Gianollo & Olivero	Gregersen	Bossuyt & Daveloose	Scivoletto	Umbach & Stolterfoht		Mari & Giannakidou	Queisser & Pleyer	Gómez-Valadés & Sansiñena	Talic	Duraj-Nowosielska	Tresoldi, Lindgren, Billing, Huisman & Ferraz Gerardi
17.30-17.55	Mansfield		DISCUSSION	Karantzola, Kostopoulos & Makri	Reshef	Van Praet & Degand	Mauri & Russo	Høeg Müller		Silvano, Gómez González & Cordeiro	Song	Torres Soler	Dyachkov	Stoynova & Khomchenova	Davis

19.30-21.30 *WELCOME RECEPTION (the central building of the National and Kapodistrian University of Athens: Panepistimiou 30, 10679 Athens)*

**WEDNESDAY 30 AUGUST**

	1	2	3	4	5	6	7	8	9	10	11	12	13	14	15
	GS Information structure	GS Morphosyntax: verbs I	GS Pragmatics	WS19	WS13 Defectivity and	GS Historical linguistics	WS4 Expressing surprise	WS14 Similarity of quality	GS Modality	WS12	WS18 Impoliteness	WS20	WS5 Inflection	GS Typology	GS Aspect

	CHAIR: <b>MIHALIS GEORGIAFENTIS</b>	CHAIR: <b>KATARZYNA JANIC</b>	CHAIR: <b>VASILIKI MAKRI</b>	Translations in the history of languages	Overabundance	CHAIR: <b>JAMES WALKER</b>			CHAIR: <b>KAROLINA GRZECH</b>	Questions in Monologic Discourse		Verbal periphrases in Romance		CHAIR: <b>LIN XIAO</b>	CHAIR: <b>AMALIA MOSER</b>
9.00-9.25	Hsieh	Inglese	Westergaard & Boye	Kölligan	Brown, Kovářiková & Bermel	De Pascale & Geeraerts	Hennemann & Döhla	Gaeta	Zubova		Kinoshita	Del Rey Quesada	Vyshnevskaya	Seržant	Suleymanov
9.30-9.55	Muravyev	Zanchi, Luraghi & Giuliani	Berner	Nardi	Bermel, Knittl & Nikolaev	Sobotka	Wiesinger, Dessì Schmid & Momma	Vassiliadou, Gerhard-Krait & Lammert	Teptiuk & Nikitina	Amon, Käsper & Treikelder	Matiello	de Toledo Y Huerta & Garachana Camarero	Borise	Kubinyi, Tamm & Tóth	Salvà i Puig
10.00-10.25	Lavissière, Dahm & Bonnard	Dahl	Beekhuizen	Ben-Ari & Bat Zeev Shyldkrot	Strobel	Rodriguez-Somolinos	DISCUSSION	Benigni & Bernasconi	Zubeldia	DISCUSSION	Hamans	Espíndola Moschner & Rosemeyer	Arsenijević, Milosavljević & Simonović	Panov	Arkadijev & Klyagina
10.30-11.30	<b>POSTER SESSION I and coffee break School of Philosophy-outside AULA</b> Kalnaca and Lokmane ■ Buzanov and Popova ■ Charitonidis ■ Mežale ■ Ha Yap, Sahoo, Medhi and Palit ■ Antono, Miguel and Costa ■ Ibarretxe-Antuñano, Ariño-Bizarro, Moret-Oliver, Moret-Oliver and Tomás-Faci ■ Holmes and Vihman ■ Andrej ■ Ovsjannikova ■ Norvik and Saar ■ Giannoula ■ Metslang and Simmul ■ Van de Weerd ■ Mazzitelli ■ Luo and Cao														
	<b>1</b>	<b>2</b>	<b>3</b>	<b>4</b>	<b>5</b>	<b>6</b>	<b>7</b>	<b>8</b>	<b>9</b>	<b>10</b>	<b>11</b>	<b>12</b>	<b>13</b>	<b>14</b>	<b>15</b>
	GS Historical phonology II CHAIR: <b>SAMI HONKASALO</b>	GS Semantics CHAIR: <b>EVANGELIA VLACHOU</b>	WS16 Sound symbolism	WS19 Translations in the history of languages	WS13 Defectivity and Overabundance	GS Interrogatives CHAIR: <b>LJUDMILA GEIST</b>	GS Grammaticalization CHAIR: <b>HENRIK BERGQVIST</b>	WS14 Similarity of quality		GS Morphosyntax: verbs CHAIR: <b>BERT CORNILLIE</b>	WS18 Impoliteness	WS20 Verbal periphrases in Romance	WS5 Inflection	GS Morphology: suffixes CHAIR: <b>SIMONE MATTIOLA</b>	GS Metaphors CHAIR: <b>KIKI NIKIFORIDOU</b>
11.30-11.55	Dufour	Salminen	Körtvélyessy, Flaksman & Akumbu	Tronci	Copot, Aigro, Vihman & Sims	Pavlidou & Alvanoudi	Boye	Stosic & Đurić		Kaye	Sahoo & Ha Yap	Amaral	DISCUSSION	Fernández-Domínguez	Carlson
12.00-12.25	Herce	Denizot & Faure	Lacina Silue	Reuelta Puigdollers	Tsompanidou	Roussou & Vlachos	von Mengden	Janebova & Martinkova		Dumitrescu	DISCUSSION	Carlier, Vangaever & Pigère		Tarasova & Sánchez Fajardo	Egg & Kordoni
12.30-13.30	<b>lunch (Modern Greek Language Teaching Centre)</b>														
13.30-14.00	<b>presentation of the new "Glossa" journal: "Glossa Contact" (Modern Greek Language Teaching Centre: Auditorium)</b>														
	<b>1</b>	<b>2</b>	<b>3</b>	<b>4</b>	<b>5</b>	<b>6</b>	<b>7</b>	<b>8</b>	<b>9</b>	<b>10</b>	<b>11</b>	<b>12</b>	<b>13</b>	<b>14</b>	<b>15</b>
	GS Language contact CHAIR: <b>IOANNA SITARIDOU</b>		WS16 Sound symbolism	WS19 Translations in the history of languages	WS13 Defectivity and Overabundance	GS Interrogatives CHAIR: <b>ORA MATUSHANSKY</b>	GS Grammaticalization CHAIR: <b>WOUT VAN PRAET</b>	WS14 Similarity of quality	WS2 Expanding the boundaries	GS Morphosyntax CHAIR: <b>MATTI MIESTAMO</b>	GS Historical syntax I CHAIR: <b>GUGLIELMO INGLESSE</b>	WS20 Verbal periphrases in Romance	WS3 Expletives	GS Morphology: suffixes CHAIR: <b>EYSTEIN DAHL</b>	GS Aspect CHAIR: <b>JAN NUYTS</b>
14.00-14.25	Mevis		Guitang & Akumbu	Bruno	Vihman, Hržica, Aigro, Košutar & Bošnjak Botica		Walker	Guz	Grzech & Bergqvist	Dobrovie-Sorin & Tudor Giurgea	Mendoza, Sonnenhauer & Wiemer	DISCUSSION	Booth & Groothuis	Renner	Trawinski

14.30-14.55	Lindström, Plado & Pilvik		Johansson	la Roi	Nikolaev & Bermel	Barros Brito	Jorge Agulló	Hemmings & Dalrymple	Bodnaruk	Ilioia	Sloboda		Milosavljević & Milosavljević	Krykoniuk	Fanego
15.00-15.25	Damnjanović		Smith	Luraghi & Zanchi	Fally & Goryczka	Radulescu		DISCUSSION	Zemp & Schindler	Taremaa, Reile & Pajusalu	Dedio		Kim & Bîlbîie		Kapkan
15.30-16.00	<i>coffee break (Modern Greek Language Teaching Centre)</i>														
	<b>1</b>	<b>2</b>	<b>3</b>	<b>4</b>	<b>5</b>	<b>6</b>	<b>7</b>	<b>8</b>	<b>9</b>	<b>10</b>	<b>11</b>	<b>12</b>	<b>13</b>	<b>14</b>	<b>15</b>
	GS Vocatives	GS Semantics	WS16 Sound symbolism	WS19 Translations in the history of languages	WS13 Defectivity and Overabundance	GS Historical linguistics	GS Sociolinguistics II	WS6 Language change	WS2 Expanding the boundaries	GS Morphosyntax	GS Language acquisition II		WS3 Expletives	GS Typology	GS Aspect
	CHAIR: <b>JAN HEEGÅRD PETERSEN</b>	CHAIR: <b>RICHARD FAURE</b>				CHAIR: <b>ANNA ROUSSOU</b>	CHAIR: <b>SPYRIDOULA BELLA</b>			CHAIR: <b>EYSTEIN DAHL</b>	CHAIR: <b>SPYRIDOULA VARLOKOSTA</b>			CHAIR: <b>KATARZYNA WOJTYŁAK</b>	CHAIR: <b>BEATA TRAWIŃSKI</b>
16.00-16.25	Kojadinovic	Trinh	Farina	Gerhalter & Enrique-Arias	İleri & Demirok	Olivier	Arroyo Hernández	Grenoble & Khanina Introduction	Singh	Payne	Żychliński, Wrembel & Skatba		Cerullo & De Cia	Xiao & Peyraube,	Polančec
16.30-16.55	Giorgi	Hsieh	Samejon	Del Rey Quesada & Carmona Yanes	Bošnjak Botica, Polančec, Musulin, Hržica & Košutar	Molenaers	Posio, Kachel & Uclés	Janhunnen	Wang & Cheung	Hledíková	Prentza, Kaltsa & Tsimpli		Hietam	Metsäranta, Honkola & Milanova	Koss
17.00-18.30	<i>ROUND TABLE: "The Study of Language Change in the 21st Century: Theories and Tools" (Aula of the School of Philosophy)</i>														
19.30-21.00	<i>CITY WALK (Melina Mercouri Monument (opposite Hadrian's Arch) <a href="https://goo.gl/maps/8mqnUYrq96UBiwHL8">https://goo.gl/maps/8mqnUYrq96UBiwHL8</a>)</i>														
<b>THURSDAY 31 AUGUST</b>															
	<b>1</b>	<b>2</b>	<b>3</b>	<b>4</b>	<b>5</b>	<b>6</b>	<b>7</b>	<b>8</b>	<b>9</b>	<b>10</b>	<b>11</b>	<b>12</b>	<b>13</b>	<b>14</b>	<b>15</b>
	GS Historical syntax II	GS Semantics	WS16 Sound symbolism	WS19 Translations in the history of languages	WS13 Defectivity and Overabundance	GS Segmentation	WS7 Left and right peripheries	WS6 Language change	WS2 Expanding the boundaries	GS Morphosyntax: NP	GS Word order	WS17 The concept of manner	WS3 Expletives	GS Typology	WS11 Pragmatic phenomena
	CHAIR: <b>CAMILLE DENIZOT</b>	CHAIR: <b>CARLA VERGARO</b>				CHAIR: <b>AIDA TALÍĆ</b>				CHAIR: <b>JESÚS FERNÁNDEZ-DOMÍNGUEZ</b>	CHAIR: <b>CHARLOTTE HEMMINGS</b>			CHAIR: <b>IJA SERŽANT</b>	
8.30-8.55	Marescotti	Huang	Carling, Allasonnière-Tang & Johansson	Dell'Oro	Saicová Římalová	Dubois & Ka Yau Lai	Klumm & Speyer	Sheifer & Bolshakova	Kubitsch	Nintemann	Sahkai, Tamm & Holmberg	Duplatre & Duffley I	Greco	Giomi & Van linden	
9.00-9.25	Zehentner	Todesk	Bagasheva	Trips	Laks	Just & Widmer	Frey	Kantarovich	Spets	Louagie, Njantcho Kouagang & Van de Velde	Palancar	Kakoyianni-Doa	Cennamo & Cerullo	Puddu & Janic	Schumann & Oswald
9.30-10.30	<i>PLENARY SESSION: Dag Haug (University of Oslo) (Aula of the School of Philosophy)</i> <i>CHAIR: KIKI NIKIFORIDOU</i>														
10.30-11.30	<i>POSTER SESSION II and coffee break School of Philosophy-outside AULA</i>														

Sobolev and Sikimic ■ Petrović ■ Curti-Contessoto ■ Yang and Trips ■ Santelmann ■ Sangregory ■ Matter ■ Carnesale ■ Zydorowicz, Jankowski, Kononenko and Dziubalska-Kotaczyk ■ Bychkova ■ Erkkilä ■ Popova ■ Ahmadi ■ Hartmann, Koch, Endesfelder Quick and Riehl ■ Socanac and Joseph ■ Petersen ■ Cao, Zhou and Hristovsky ■ Ishihara															
	1	2	3	4	5	6	7	8	9	10	11	12	13	14	15
	GS Information structure	WS9 Locative and existential	WS16 Sound symbolism	WS19 Translations in the history of languages	WS13 Defectivity and Overabundance	GS Historical Syntax III	WS7 Left and right peripheries	WS6 Language change	WS2 Expanding the boundaries	GS Morphosyntax: Pronouns	WS10 On the spatial	WS17 The concept of manner	WS3 Expletives	GS Typology	WS11 Pragmatic phenomena
	CHAIR: ENRIQUE L. PALANCAR					CHAIR: PIOTR SOBOTKA				CHAIR: ANGELIKI TSOKOGLOU				CHAIR: MIHALIS MARINIS	
11.30-11.55	Brysbaert & Lahousse	Budzisch, Basile & Däbritz	Gruzdeva	Pedrazzini & Haug	Roncero, Bermel & Russell	Nakamura	van der Wouden & Foolen	Stoynova	Zhou	Giurgea & Ivan	Enrique-Arias, de Benito Moreno & del Barrio de La Rosa	Mirto	Petrova	Rakhilina, Reznikova & Ryzhova	Martyc
12.00-12.25	Levshina, Garcia, Skyra & Petukhova	Haspelmath	Montébran	Biagetti & Brigada Villa	Balo	Wiemer, Kölligan & Kümme	Monforte & Coniglio	Klyachko	Bendezú-Araujo	Diem & Davis	Robecchi	Mithun	Biberauer	Cane	Stern & Jacquin
12.30-12.55	Lombardi Vallauri, Masia & Giunta	Juarez		Fuchsbauer & Maion	Kapatsinski	Cattafi		Pupynina	Nourzaei	Rozhanskiy & Markus	Onea & Scherr	König & Vezzosi	DISCUSSION	Janic, Stronski & Tavakoli	Yamamori
13.00-14.00	lunch (Modern Greek Language Teaching Centre)														
	Modern Greek Language Teaching Center: Auditorium	2	3	4	5	6	7	8	9	10	11	12	13	14	15
	Discussion: public outreach of linguistics in Europe	WS9 Locative and existential	WS16 Sound symbolism	WS19 Translations in the history of languages	WS13 Defectivity and Overabundance	WS15 Sociotypology	WS7 Left and right peripheries	WS6 Language change	WS2 Expanding the boundaries	GS Morphosyntax: verbs	WS10 On the spatial	WS17 The concept of manner	WS8 Linguistics of Weather	GS Typology	WS11 Pragmatic phenomena
										CHAIR: TERESA FANEGO				CHAIR: SVETLANA BERIKASHVILI	
14.00-14.25		Kampanarou	Marsault	Yakovenko	Parker	Benitez Burraco	Mustafa & Kaltenböck	Matic & Nikolaeva	Döhler	Fleissner, Ruf & Smirnova	Hübler & Greenhill	Izutsu, Izutsu & Kim	Paykin & Meulleman	Khomchenkova	Zubia
14.30-14.55		Panova & Liljegren	Dahlgren & Kittilä	Kaltenbach	DISCUSSION	Chen et al.	Berthe & Fetzer	Bergelson, Kibrik & Raskladkina	Shor, Inbar & Izre'El	Ioannou	Kawasaki	Nakamura	Eythorsson & Sigurdardottir	Cristofaro	Garmendia
15.00-15.25		Karakoç	Van Hoey	Parina, Sackmann, Meelen & Willis		Allasonnière-Tang & Chacon	Pinson	Vesakoski, de Heer, Dunn, Huisman, Jing, Norvik & Tresoldi	Pérez Ocón	Masia & Biasio	Guzmán Naranjo, Mertner & Urban	Fukushima	Sarda	Fedriani & Napoli	Amido
15.30-16.00	coffee break (Modern Greek Language Teaching Centre)														



	1	2	3	4	5	6	7	8	9	10	11	12	13	14	15
	GS Information structure	WS9 Locative and existential	WS16 Sound symbolism	WS19 Translations in the history of languages	GS Sociolinguistics III	WS15 Socio-typology	WS7 Left and right peripheries	WS6 Language change	WS2 Expanding the boundaries	GS Morphosyntax: verb	WS10 On the spatial	WS17 The concept of manner	WS8 Linguistics of Weather	GS Typology	WS11 Pragmatic phenomena
	CHAIR: <b>KAREN LAHOUSSE</b>				CHAIR: <b>SPYRIDOULA BELLA</b>					CHAIR: <b>VIVIANA MASIA</b>				CHAIR: <b>AN VAN LINDEN</b>	
16.00-16.25	Georgiafen tis & Tsokoglou	Budzisch	Ibarretxe-Antuñano	Alfimova	Stavridou	Brigada Villa & Talamo	Mittendorfer	Roose, Nylén, Tolvanen & Vesakoski	Miecznikowski & Battaglia	Adamou & Arslan	Liljegren	Georgieva	Jódar Sánchez	Barotto & Sansò	Cominetti & Lombardi Vallauri
16.30-16.55	Pompei	Michaelis	Moreno Cabrera	DISCUSSION	Koutroubas	Gil	Klævik-Pettersen	Dunn	Ballarè & Mauri	Jarrah & Jaradat	Drinka	Stern & Reshef	Kulikov	Perković	de Oliveira Fernandes & Oswald
17.00-19.00	<i>ANNUAL MEMBERS' MEETING (Aula of the School of Philosophy)</i>														
20.00-0.00	<i>CONFERENCE DINNER (Apostolou Pavlou 25, Thissio)</i>														
<b>FRIDAY 1 SEPTEMBER</b>															
9.30-9.55	<i>PLENARY SESSION: Tammy Ganster (Best PhD winner) (Aula of the School of Philosophy)</i> CHAIR: <b>AMALIA MOSER</b>														
10.00-10.25	<i>PLENARY SESSION: Lena Borise (Best Postdoc winner) (Aula of the School of Philosophy)</i> CHAIR: <b>AMALIA MOSER</b>														
10.30-11.00	<i>coffee break (Modern Greek Language Teaching Centre)</i>														
	1	2	3	4	5	6	7	8	9	10	11	12	13	14	15
	GS Semantics	WS9 Locative and existential	WS16 Sound symbolism	GS Language acquisition		WS15 Socio-typology	WS7 Left and right peripheries	WS6 Language change	WS2 Expanding the boundaries	GS Morphosyntax	WS10 On the spatial	WS17 The concept of manner	WS8 Linguistics of Weather		WS11 Pragmatic phenomena
	CHAIR: <b>TATIANA NIKITINA</b>			CHAIR: <b>MICHAEL PLEYER</b>						CHAIR: <b>MARIA KALTSA</b>					
11.00-11.25	Kor Chahine	Knudsen, Ennever & Yacopetti	Malysheva & Flaksman	Khachatryan & Reuland		Rangelov	Zeman	Berge	Müller	Jarrah & Jaradat	Arkhangelskiy	Cacioli	Risler		Younis, Schumann, Herman, de Oliveira Fernandes & Oswald
11.30-11.55	Fassi Fehri	Däbritz	Schaefer & Egbokhare	Lahousse & Jourdain		McWhorter	Ott	Khanina & Gusev	Aijmer	Istrate, Abeillé, Bilbûie & Hemforth	Kellert	Delhem	Meulleman & Paykin		Cominetti, Mannaioli, Giunta, Masia, De Marco & Lombardi Vallauri
12.00-12.25	Viberg	Klump & Basile	Georgescu & Georgescu	Hijazo-Gascón & Andria		Sinnemäki, Di Garbo, Kashima, Napoleão de Souza & Ellison	Lehmann, Sameri, Mortezapour, Verhoeven & Adli	Kibrik	Modicom	Tesfu Dires	Martínez Martínez & Pérez-Saldanya	Hummel	DISCUSSION		Kikteva, Schumann, Hautli-Janisz & Oswald

12.30-12.55		Guerrero & Belloro	Kratochvil, Saad & Delpada	Knouzi		DISCUSSION	Heegård Petersen	Koryakov	DISCUSSION	Romagno & Marescotti	Gomila Albal	DISCUSSION			DISCUSSION
13.00-13.25		DISCUSSION	DISCUSSION	Barkaoui			DISCUSSION			Nikishina & Letuchiy	DISCUSSION				
13.30-14.00	CLOSING SESSION and BEST PRESENTATION AWARDS ( <i>Aula of the School of Philosophy</i> )														
14.00-15.00	lunch ( <i>Modern Greek Language Teaching Centre</i> )														
16.00	<b>Excursion</b> Acropolis & Acropolis Museum Cape Sounion and the Temple of Poseidon														
SATURDAY 2 SEPTEMBER															
	<b>Excursion</b> Argolis (Mycenae, Nafplio & Epidaurus) Delphi Ancient Corinth, Canal Cruise, Swimming & Lunch One Day Cruise (Hydra, Poros, Aegina)														